

PRESSURE SWITCH



General Description

- For use with fluorinated refrigerants as well as with air and water (Allowable Fluid temp:-40 to 135°C)
- Type HPS for Universal application.
- Micro-switch ensures reliable switching
- Mounting Bracket supplied as standard
- With SPDT contact mechanism

Electrical Ratings

Rated Voltage(v)	AC 125V	AC 250V
Rated Amps(a)		
Non-Inductive Current	10A	5A
Full Load	8.5A	4.5A
Starting	40A	20A

Contact Function

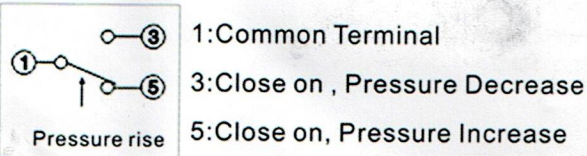

Specifications

Model No	Range		Differential		Factory Setting		Max. Bellows Pressure (Kgf/cm ²)	Wt(Kg)
	Min	Max	Min	Max	Off(On)	ON(Off)		
SNS-C103X	-0.5	3	0.35	2	0.5	1.5	10	0.33
SNS-C104X	-0.5	4	0.4	2	1	2	15	
SNS-C106X	-0.5	6	0.6	4	2	3	15	
SNS-C110X	1	10	1	3	4	6	15	
SNS-C120X	5	20	2	5	12	15	30	
SNS-C130X	5	30	3	10	20	25	33	

Appearance Drawing

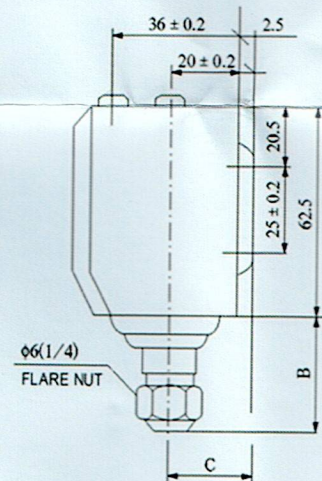
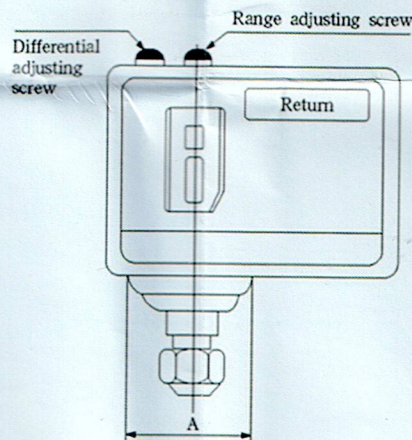
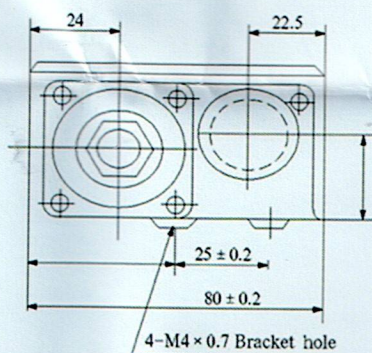

A	B	C
38.5	38.9	22.4
34.4	36	22.4
34.4	36	22.4
22	32.7	18.5